

Exploded View & Miscellaneous Parts

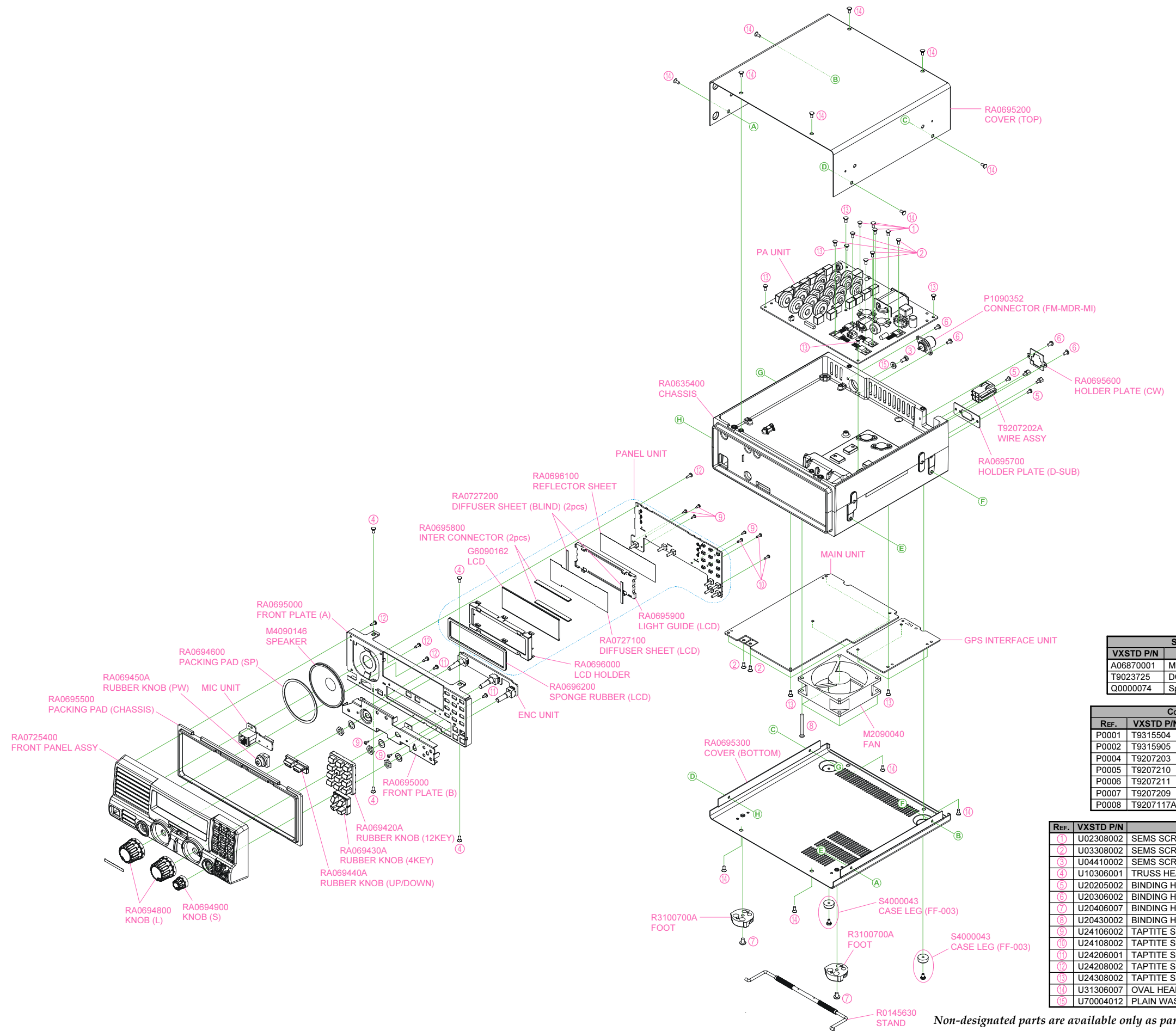

SUPPLIED ACCESSORIES		
VXSTD P/N	DESCRIPTION	QTY.
A06870001	MH-31A&J Hand Microphone	1
T9023725	DC Power Cord	1
Q0000074	Spare Fuse (25 A Blade Type)	1

CONNECTION CABLES		
REF.	VXSTD P/N	DESCRIPTION
P0001	T9315504	Coaxial Cable (J1001+J2006)
P0002	T9315905	Coaxial Cable (J1002+J2001)
P0004	T9207203	30-pin Flat Cable (J1003+J2002)
P0005	T9207210	13-pin Molex (J1008+J4001)
P0006	T9207211	8-pin Molex (J1005+J6002)
P0007	T9207209	8-pin Molex (J3004+J6101)
P0008	T9207117A	30-pin Flat Cable (J1004+J3001)

REF.	VXSTD P/N	DESCRIPTION	QTY.
①	U02308002	SEMS SCREW SM3X8NI	4
②	U03308002	SEMS SCREW ASM3X8NI	7
③	U04410002	SEMS SCREW HSM4X10NI	1
④	U10306001	TRUSS HEAD SCREW M3X6	4
⑤	U20205002	BINDING HEAD SCREW M2.6X5NI	2
⑥	U20306002	BINDING HEAD SCREW M3X6NI	4
⑦	U20406007	BINDING HEAD SCREW M4X6B	2
⑧	U20430002	BINDING HEAD SCREW M4X30(Ni)	4
⑨	U24106002	TAPTITE SCREW M2X6NI	6
⑩	U24108002	TAPTITE SCREW M2X8NI	3
⑪	U24206001	TAPTITE SCREW M2.6X6	2
⑫	U24208002	TAPTITE SCREW M2.6X8NI	4
⑬	U24308002	TAPTITE SCREW M3X8NI	14
⑭	U31306007	OVAL HEAD SCREW M3X6B	12
⑮	U70004012	PLAIN WASHER FW4BSNI	1

Non-designated parts are available only as part of a designated assembly.